

Gege for External Measurement MaraMeter 838 TA



Application:

- For measuring thicknesses and wall thicknesses
- Easy to operate, very habile and portable

Features

Contact points are made from carbide

- Absolute measuring instrument
- Easy to read tolerance markers
- **IP protection category:** IP 65
- **Scope of delivery:** Test certificate

Technical Data

NEW

Artikel-Nr.		4495550	4495551	4495552	4495555	4495556
Measuring range	mm	0 – 10	0 – 20		0 – 50	
Readings	mm	0.005	0.01		0.05	
Error limit	mm	0.015	0.03		0.05	
Repeatability	mm	0.005	0.01		0.025	
Measuring depth mm	mm	35	85		167	169
Measuring contact ball \varnothing	mm	1.5			3	
Measuring force (text)	N	0.8 – 1.2	1.1 – 1.6		0.8 – 1.7	

Order No	DIM D	DIM Hb	DIM Hf	DIM L
	mm	mm	mm	mm
4495550	1.5	19.1	18.6	35
4495551	1.5	24.6	24.6	85
4495552	1.5	24.6	2.5	85
4495555	3	30	30	167
4495556	3	30	4.3	169

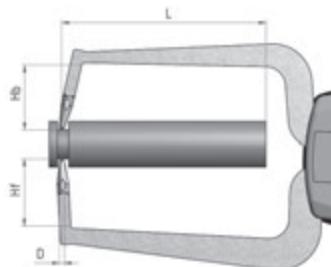

Electronic Gage for External Measurement MaraMeter 838 EA

Features

Functions:

ON/OFF, mm/inch, TOL (enter tolerance limit values), ABS (display can be set to zero, without losing the reference to the Preset value), DATA (Data transmission via connection cable)

- High contrast analog and digital LCD
- Tolerance is displayed with 2 LEDs
- **Data interface:** Digimatic, USB
- **Energy supply:** Battery operation
- **IP protection category:** IP 67
- **Scope of delivery:** Instruction manual, Battery, Test certificate



Application:

- Specified measuring programs according to application
- Absolute/Relative measuring program

Technical Data

NEW

Artikel-Nr.		4495560	4495561	4495562	4495563	4495564	4495565	4495566
Measuring range	mm	0 – 10	0 – 20		0 – 30	0 – 50	0 – 30	0 – 50
Readings	mm	0.005	0.01		0.02			
Error limit	mm	0.015	0.03		0.04	0.06	0.04	0.06
Repeatability	mm	0.005	0.01		0.02	0.04	0.02	0.04
Measuring depth mm	mm	35	85		116	167	116	169
Measuring contact ball \varnothing	mm	1.5			3			
Measuring force (text)	N	0.8 – 1.2	1.1 – 1.6		0.9 – 1.6	0.8 – 1.7	0.9 – 1.6	0.8 – 1.7

Order No	DIM D	DIM Hb	DIM Hf	DIM L
	mm	mm	mm	mm
4495560	1.5	19.1	18.6	35
4495561	1.5	24.6	24.6	85
4495562	1.5	24.6	2.5	85
4495563	3	30	30	116
4495564	3	30	30	167
4495565	3	30	4	116
4495566	3	30	4.3	169

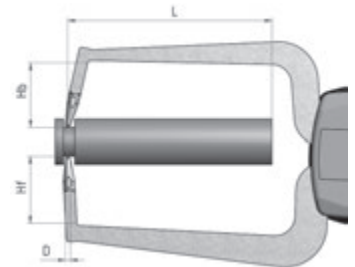

Accessories

OrderNo	Product description	Product type
4243073	Battery Alkaline AAA 1,5 V	
4495079	Data Connection Cable USB (1.5m)	838 usb
4495083	Data Connection Cable Digimatic (1.5m)	838 di (A)

Gage for Internal Measurement MaraMeter 838 TI



Application:

- For measuring bores and internal grooves
- Easy to operate, very habile and portable

Features

- Easy to read tolerance markers
- Contact points are made from carbide
 - Absolute measuring instrument
 - **IP protection category:** IP 65
 - **Scope of delivery:** Test certificate

Technical Data

NEW

Artikel-Nr.		4495580	4495581	4495582	4495583	4495584	4495585	4495586	4495587
Measuring range	mm	5 - 15	10 - 30	20 - 40	30 - 50	40 - 60	50 - 70	15 - 65	40 - 90
Readings	mm	0.005			0.01			0.05	
Error limit	mm	0.015			0.03			0.05	
Repeatability	mm	0.005			0.01			0.025	
Measuring depth mm	mm	35			85			188	192
groove depth	mm	2.3	5.2	7		8.3		5.5	8.3
Groove width	mm	0.8			1.2			1.9	2.4
Measuring contact ball Ø	mm	0.6			1			1.5	2
Measuring force (text)	N	0.8 - 1.2			1.1 - 1.6			0.9 - 1.9	

Order No	DIM A	DIM B	DIM D	DIM Hb	DIM Hf	DIM L
	mm	mm	mm	mm	mm	mm
4495580	2.30	0.80	0.6	2.5	35	35
4495581	5.20	1.20	1	5.4	85	85
4495582	7.00	1.20	1	7.3	85	85
4495583	7.00	1.20	1	7.3	85	85
4495584	8.30	1.20	1	12.2	85	85
4495585	8.30	1.20	1	12.2	85	85
4495586	5.50	1.90	1.5	6	6	188
4495587	8.30	2.40	2	8.5	8.5	192

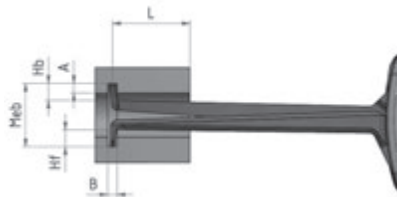

Electronic Gage for Internal Measurement MaraMeter 838 EI

Features

Functions:

ON/OFF, mm/inch, ABS (display can be set to zero, without losing the reference to the Preset value), TOL (enter tolerance limit values)

- High contrast analog and digital LCD
- Tolerance is displayed with 2 LEDs
- **Data interface:** Digimatic, USB
- **Energy supply:** Battery operation
- **IP protection category:** IP 67
- **Scope of delivery:** Instruction manual, Battery, Test certificate



Application:

- Specified measuring programs according to application
- Absolute/Relative measuring program

Technical Data								NEW		
Artikel-Nr.		4495590	4495591	4495592	4495593	4495594	4495595	4495598	4495599	4495600
Measuring range	mm	5 - 15	10 - 30	20 - 40	30 - 50	40 - 60	50 - 70	13 - 43	30 - 60	50 - 80
Readings	mm	0.005			0.01			0.02		
Error limit	mm	0.015			0.03			0.04		
Repeatability	mm	0.005			0.01			0.02		
Measuring depth mm	mm	35			85			127	132	
groove depth	mm	2.3	5.2	7	8.3		5.7	6.2	8.3	
Groove width	mm	0.8			1.2		1.6	1.8	2.4	
Measuring contact ball \varnothing	mm	0.6			1		1.3	1.5	2	
Measuring force (text)	N	0.8 - 1.2			1.1 - 1.6		1.2 - 1.7			

Order No	DIM A	DIM B	DIM D	DIM Hb	DIM Hf	DIM L
	mm	mm	mm	mm	mm	mm
4495590	2.30	0.80	0.6	2.5	2.5	35
4495591	5.20	1.20	1	5.4	5.4	85
4495592	7.00	1.20	1	7.3	7.3	85
4495593	7.00	1.20	1	7.3	7.3	85
4495594	8.30	1.20	1	12.2	12.2	85
4495595	8.30	1.20	1	12.2	12.2	85
4495598	5.70	1.60	1.3	5.7	5.7	127
4495599	6.20	1.80	1.5	6.5	6.5	132
4495600	8.30	2.40	2	8.5	8.5	132

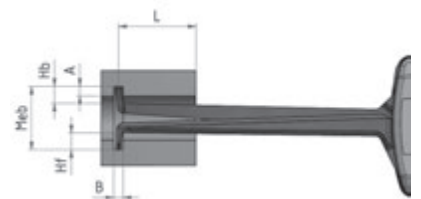

Accessories

OrderNo	Product description	Product type
4243073	Battery Alkaline AAA 1,5 V	
4495079	Data Connection Cable USB (1.5m)	838 usb
4495083	Data Connection Cable Digimatic (1.5m)	838 di (A)